

GREEN FEATURES

- Potential for roof top Photovoltaic electrical system
- Individual gas and electric meters for all units
- Apollo type heaters from individual hot water heaters
- Within high density TOD development
- Walking distance to community resources and transit
- Energy Star Rated Appliances, all fluorescent lighting
- Low E hard coat dual glazing
- Certified Wood
- Low water use landscaping

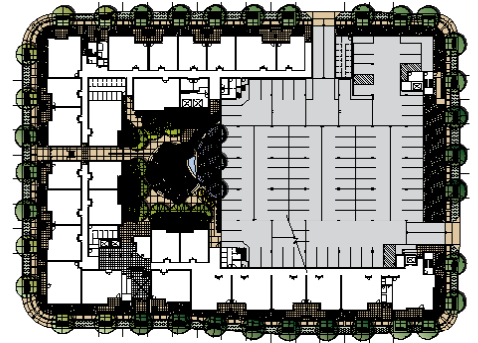

BLOCK 5 SITE PLAN

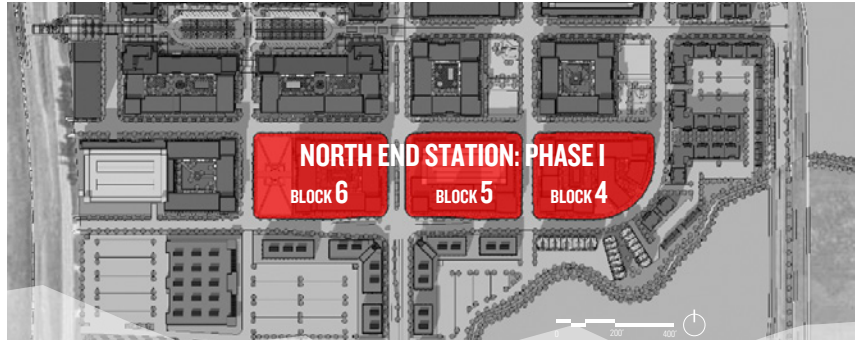

BLOCK 6 S. ELEVATION

Client:

Thornton Gateway Properties LLC

Building size/acres:

455 units/6.1 acres

Density: 74.5 du/ac

Completion: TBD

Construction est.: TBD

Contact:

Terry Erwin
5596 S. Lansing
Englewood, CO 80111
720.628.8437

DESIGN FEATURES

- Architecture engages public park
- Courtyard provides secure outdoor living areas for residents
- multi-purpose rooms and rentable work spaces for residents





BLOCK 5 S. ELEVATION

BLOCK 4 S. ELEVATION

NORTH END STATION PHASE I

THORNTON, CO

Phase I Sets Precedent for New Development

DESCRIPTION Phase I of North End Station is composed of 3 residential blocks introducing the new development. Our task of Phase I design was in establishing a precedent for the future buildings. There is no there, there yet. We are creating it. We needed to conceive and appropriate a sense of openness and freedom not bound by stylistic architectural preconceptions. The urban design of the overall North End Station development plan follows best urban design and Transit Oriented Development (TOD) practices, which allows freedom of architectural expression within the interpretations of the design guidelines and will inherently allow uniqueness yet also set commonalities between the buildings of Phase I as well as future building in the development.

Energy conservation is a key tenet the client wishes to promote with all development within North End Station. The buildings for Phase I are designed to promote healthy living and energy conservation by incorporating sustainable materials and energy efficient systems. Phase I is to be a model for new development by demonstrating various layers of benefit to the residents, the community, and the environment.