



NOTRE DAME PLAZA

SAN FRANCISCO, CA

Creating Community in a Historic Framework

DESCRIPTION Notre Dame Plaza is an adaptive re-use of the historic 1907 Notre Dame High School into affordable senior housing. This project involves the comprehensive transformation and preservation of existing buildings and grounds and the new construction of courtyards, accessways and other housing related components. The transformation of the Notre Dame building into 66 units of HUD 202 senior housing includes a new lobby, community room, gardens, reading areas and a 2 story skylighted aviary. All historic elements were preserved while maximizing the amount of units that could fit comfortably into the existing building.

VISION Create a light filled, active environment that respects the building's historic nature.

PROJECT REQUIREMENTS Modify the existing structure and grounds to meet new use while respecting the historical overlay district and diverse community.

DESIGN FEATURES

- Restoration of building facade
- Creation of new accessible entry for residents
- Utilization of generous ceiling heights and tall windows
- Installation of new building systems
- Restore and enhance public spaces

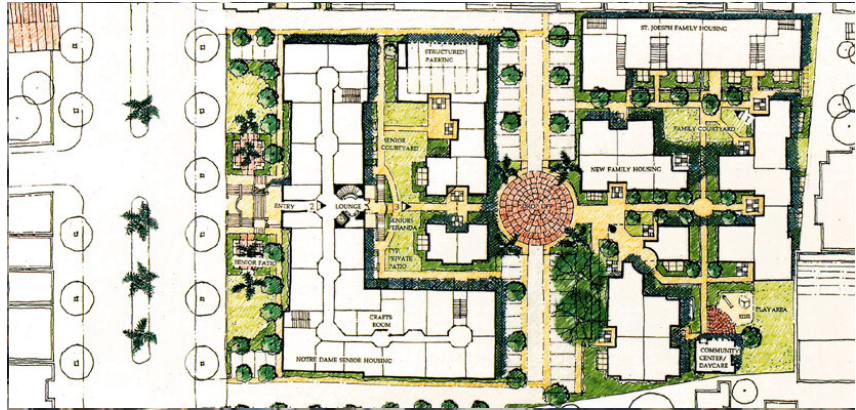

Client: Mercy Housing California

Building size/acres: 53,000 sq.ft./
1.75 acre

Density: 66 units

Completion: August 1997

Construction est.: \$6.3M

Contact:

Barbara Gualco
Mercy Housing California
1360 Mission Street #300
San Francisco, CA 94103
415.355.7100

Scott Smith
Roberts-Obayashi Corp.
20 Oak Court
Danville, CA 94526
925.820.0600

