



# SCHLAGE LOCK MASTER PLAN

## VISITACION VALLEY, SAN FRANCISCO, CA

### A New Sustainable Neighborhood for Visitacion Valley

**DESCRIPTION** The Visitacion Valley/Schlage Lock Master Plan redevelops the 20-acre brownfield site into a vibrant mixed-use and transit-oriented neighborhood. The project is at the southern edge of San Francisco and the northern end of the future Baylands development. The new neighborhood extends the city grid across Bayshore Avenue and provides a new center to Visitacion Valley with three new parks, an extension of Leland Avenue, Visitacion Valley's "Main Street," and a possible location for a much needed grocery store. The project is a LEED-ND Pilot project and includes comprehensive stormwater management, brown-field cleanup, and green building requirements

**VISION** Stitch together two San Francisco neighborhoods and enhance the existing Visitacion Valley neighborhood through a project that is at the forefront of sustainable design.

**PROJECT REQUIREMENTS** Develop a plan for the former Schlage Lock site that provides housing, community open space, neighborhood serving retail, community services, and helps revitalize Leland Avenue.



## DESIGN FEATURES

- Increased connectivity
- Three new public parks
- Extension of Leland Avenue (Visitation Valley's "Main Street")
- Connection to future Baylands Development



## GREEN FEATURES

- LEED-ND Pilot Project
- Brownfield Development
- Transit-Oriented Development
- A comprehensive strategy for stormwater management, collection, filtration and environmental education facilities on site

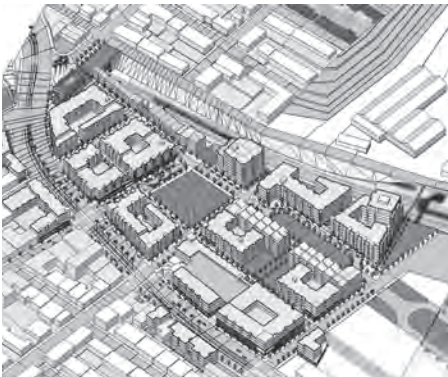

**Client:** San Francisco Planning Dept

**Building size/acres:** 20 acres

**Density:** 900 - 1300 units

**Design Fee:** \$125,000

**Infrastructure Cost:** \$35-40m  
(estimated)

**Date:** 2005-2007

**Project Manager:** Chris Sensenig

**Firm Role:** Master Plan Architect

**Contact:**

Ken Rich

Mayor's Office of Economic &  
Workforce Development

San Francisco

City Hall, Room 448

One Dr. Carleton P. Goodlett Pl.

San Francisco, CA 94102

415.554.5194